



## Airbus ACJ319 SN3133

---

**Entry Into Service:** December 2009  
**Time Since New:** 3,102:20  
**Cycles Since New:** 784 Cycles

- > 17 Passenger Configuration
- > 5 ACTs Installed

# Airbus

## ACJ319 SN3133

---

### AIRFRAME

Manufacturer / Model	Airbus ACJ319-115 ACJ
Serial Number	3133
Airframe TSN / CSN	3,102:20Hours / 784

### ENGINES

Manufacturer / Model	CFM International CFM56-5B7/P
Engine #1 TSN / CSN	3,102:20 Hours / 784
Engine #2 TSN / CSN	3,102:20 Hours / 784

### APU

Manufacturer / Model	Hamilton Sundstrand APS 3200
APU TSN / CSN	2,081 Hours / 3,715

### HIGHLIGHTS

17 Passenger Configuration
5 ACTs Installed

*Specifications are subject to verification upon inspection*



# Airbus

## ACJ319 SN3133

### AVIONICS

Two (2) Flight Management Guidance Computer

---

Two (2) Multi-Mode Receiver

---

One (1) Fixed ELT

---

Two (2) HF Transceiver

---

One (1) Cockpit Voice Recorder

---

One (1) SELCAL Decoder

---

Three (3) VHF Transceiver

---

One (1) FDR

---

Two (2) ADF Receiver

---

Two (2) ATC Transponder

---

Two (2) DME

---

One (1) EGPWS Computer

---

Three (3) Air Data Inertial Reference Unit

---

Two (2) Multi-Mode Receiver

---

Two (2) Radio Altimeter

---

One (1) TCAS System Processor

---

Two (2) VOR MKR Receiver

---

One (1) Weather Radar Transceiver

---

RVSM Compliance

---

SATCOM upgrade to Swift BroadBand

---

### WEIGHTS

Maximum Take Off Weight	168,653 LBS / 76,500 KG
Maximum Landing Weight	137,788 LBS / 62,500 KG
Maximum Zero Fuel Weight	128,970 LBS / 58,500 KG
Maximum Taxi Weight	169,535 LBS / 76,900 KG
Basic Empty Weight	103,582 LBS / 46,984 KG
Fuel Capacity	37,519 L / 9,912 USG with 5 ACTs

*Specifications are subject to verification upon inspection*



# Airbus ACJ319 SN3133

## INTERIOR

<b>Configuration:</b>	Seventeen (17) Passengers
<b>Guest Room:</b>	In The First Section (Guest Room), There is a Divan and an Armchair. A Flat TV Set is Installed on The Aft Wall
<b>Fwd Lounge:</b>	The Second Section is a Guest Room with Eight (8) Seats. There are Three (3) Cream Color Divans, Two (2) Black Armchairs which could be Converted Into Beds, and Two (2) Dark Brown Tables
<b>Aft Lounge:</b>	The Third Section is an Office, Having Six (6) Black-Brown Seats. All the Armchairs could be Converted Into Beds; There is Also a Dark Brown Folding Table and an Inbuilt Recessed Flat Screen TV
<b>Master Stateroom:</b>	The Fourth Section is a Bedroom. There is a Double Bed, and One (1) Equipped Office Station. A Flat Screen TV is on the Front Wall (Looking Forward)
<b>Lavatories Location:</b>	One (1) Behind the Cockpit on the Left Side (for the Crew), One (1) in the Central Part of the Passenger Cabin on the Right Side (for Guests) and One (1) in the Tail Part of the Passenger Cabin, in Combination with a Shower

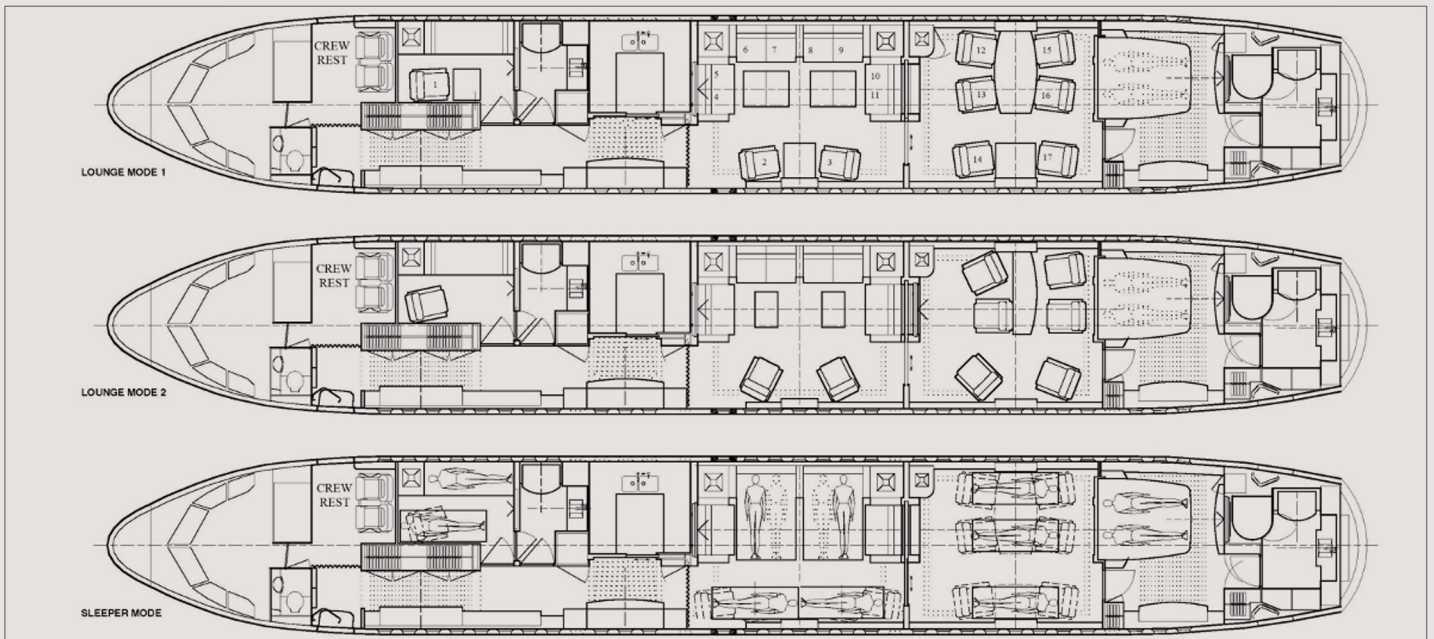

*Specifications are subject to verification upon inspection*



# Airbus ACJ319 SN3133

---



FWD ENTRANCE



# Airbus ACJ319 SN3133

---



GALLEY



# Airbus ACJ319 SN3133

---



## GUEST ROOM



Airbus  
ACJ319 SN3133

---



FWD GUEST LAVATORY





# Airbus ACJ319 SN3133

---



## FWD VIP LOUNGE



# Airbus ACJ319 SN3133

---



## FWD VIP LOUNGE



# Airbus ACJ319 SN3133

---



## FWD VIP LOUNGE



# Airbus ACJ319 SN3133

---



## AFT LOUNGE



Airbus  
ACJ319 SN3133

---



AFT LOUNGE



# Airbus ACJ319 SN3133

---



## MASTER STATEROOM



Airbus  
ACJ319 SN3133

---



MASTER STATEROOM



Airbus  
ACJ319 SN3133

---



MASTER STATEROOM





Airbus  
ACJ319 SN3133

---



MASTER LAVATORY



Airbus  
ACJ319 SN3133

---



MASTER LAVATORY





# ÔPUS aero

Follow @opusaero on



Opus Aeronautics - Le Prince de Galles - 10, avenue de Grande Bretagne - MC 98000 Monaco  
+377 9798 8108 | info@opusaero.com  
www.opusaero.com

